

35 链轮

35 SPROCKETS

Pitch 节距: 9.525
 Inner width 内节内宽: 4.78
 Roller-ø 滚子直径: 5.08

Teeth	groove width	measure Diam
9		17
10		20
11	4.4	23
12		26
13		29

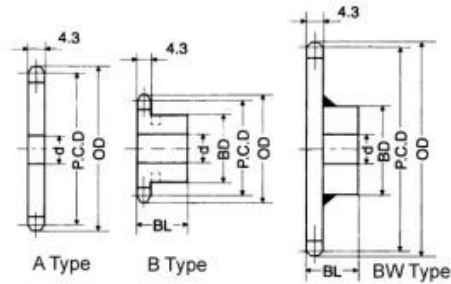

Dimensions: millimeters

齿数 No. of Teeth	外径 Outside Diam. OD	节径 Pitch Diam. P.C.D	底径 Bottom or Caliper Diam.	B 型单排 Type "B" SINGLE STRAND				A 型 TYPE "A"				
				搭子 HUB		工艺孔 Stock Bore	最大加工孔 Max Bore	重量 Wt.kg	材料 Material	工艺孔 Stock Bore	重量 Wt.kg	材料 Material
				直径 BD	总高 BL							
9	32	27.85	22.35	★21.5	20	8.5	11	0.06	S45C	9		
10	34	30.82	25.74	★24.5	20	8.5	12	0.08		9	0.02	
11	38	33.81	28.38	★27	20	9.5	14	0.09		9	0.03	
12	41	36.80	31.72	★30.5	20	9.5	16	0.12		9	0.03	
13	44	39.80	34.43	★32	20	9.5	18	0.12		9	0.04	
14	47	42.81	37.73	32	20	9.5	18	0.12		9	0.04	
15	51	45.81	40.48	35	20	9.5	20	0.16		9	0.05	
16	54	48.82	43.74	37	20	9.5	20	0.19		9	0.05	
17	57	51.84	46.54	41	20	11.5	25	0.22		11	0.07	
18	60	54.85	49.77	44	20	11.5	25	0.25		11	0.07	
19	63	57.87	52.59	47	20	11.5	28	0.28		11	0.09	
20	66	60.89	55.81	50	20	11.5	30	0.32		11	0.09	
21	69	63.91	58.65	53	20	11.5	32	0.36		11	0.11	
22	72	66.93	61.85	56	20	11.5	35	0.37		11	0.11	
23	75	69.95	64.71	60	20	11.5	38	0.38		11	0.11	
24	78	72.97	67.89	53	22	11.5	32	0.43		11	0.14	
25	81	76.00	70.77	53	22	11.5	32	0.44		11	0.16	
26	84	79.02	73.94	53	22	11.5	32	0.45		11	0.16	
27	87	82.05	76.83	53	22	11.5	32	0.46		11	0.17	
28	90	85.07	79.99	53	22	11.5	32	0.48		11	0.18	
29	93	88.10	82.89	53	22	11.5	32	0.49				
30	96	91.12	86.04	53	22	11.5	32	0.51		11	0.23	
31	99	94.15	88.95	53	22	11.5	32	0.53				
32	102	97.18	92.10	53	22	11.5	32	0.54		11	0.27	
33	105	100.20	95.01	53	22	11.5	32	0.56		11	0.28	
34	109	103.23	98.15	53	22	11.5	32	0.57		11	0.29	
35	112	106.26	101.07	53	22	11.5	32	0.59		11	0.30	
36	115	109.29	104.21	53	22	12.5	32	0.61		12	0.32	
37	118	112.31	107.13	63	25	12.5	42	0.80			SS41	
38	121	115.34	110.26	63	25	12.5	42	0.82				
39	124	118.37	113.23	63	25	12.5	42	0.84	12	0.41		
40	127	121.40	116.32	63	25	12.5	42	0.85	12	0.43		
41	130	124.43	119.26	63	25	16	42	0.91				
42	133	127.46	122.38	63	25	16	42	0.93				
43	136	130.49	125.32	63	25	16	42	0.95	16	0.43		
44	139	133.52	128.44	63	25	16	42	0.97				
45	142	136.55	131.38	63	25	16	42	1.00				
46	145	139.58	134.50	63	25	16	42	1.01	16	0.49		
47	148	142.61	137.45	63	25	16	42	1.03	16	0.51		
48	151	145.64	140.56	63	25	16	42	1.05				
50	157	151.70	146.62	63	25	16	42	1.07	16	0.60		
53	166	160.78	155.63	63	25	16	42	1.09				
54	169	163.81	158.73	63	25	16	42	1.10	16	0.70		
55	172	166.85	161.70	63	25	16	42	1.25	16	0.71		
60	187	182.00	176.92	63	25	16	42	1.30	16	0.80		
64	200	194.12	189.04	63	25	16	42	1.46				
65	203	197.15	192.07	68	25	16	45	1.67				
70	218	212.30	207.22	68	25	16	45	1.80				
75	233	227.46	222.33	68	25	16	45	1.90				
80	248	242.61	237.53	68	25	16	45	2.40	16	1.50		

NOTE:
 • Data in colored box imply teeth hardening.
 • Shaft hole, key groove and tap hole can be machined upon request.
 • Other sprockets than listed may be manufactured. For details, contact us.
 • Sprocket marked with ★ has a groove all the external circumference of boss. See Groove Dimension table above.